

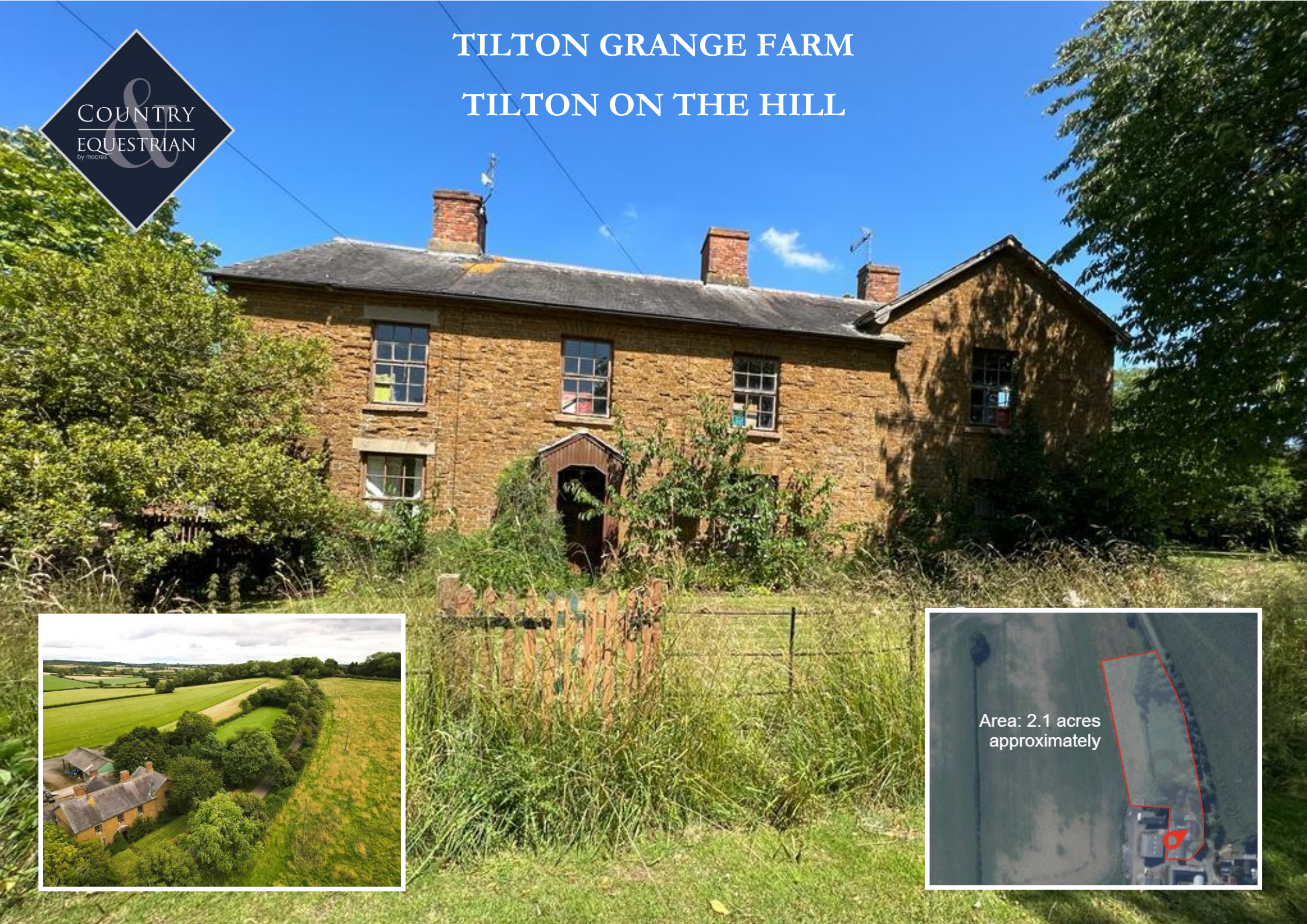

TILTON GRANGE FARM TILTON ON THE HILL





Tilton Grange Farm is idyllically set on the edge of the popular village of Tilton On The Hill, with good amenities and excellent access to the A47 giving quick access to Leicester and mainline trains to London from Market Harborough.

Tilton Grange Farm offers a substantial farmhouse with excellent proportions. The property does require full restoration, but offers all the potential to be made into a prestigious country home in a quiet rural setting. The property is set within mature gardens with an adjacent grass paddock which has been previously used for and is registered as a Caravan Club campsite with electric points etc. The property also gives a stone building “The Mill” currently used as storage and workshop space, but with planning permission applied for conversion to a 2 bedroom property / annexe potential.

Tilton on the Hill is situated close to the Rutland/Leicestershire border and is a hill top village with local facilities including a Post office/general store and a popular public house. The village is particularly well situated for fast access into Oakham, the B6047, the A1 lies to the east and A14 to the south. The nearby local beauty spot of Rutland Water offers many leisure pursuits and scenic walks. The A47 just to the west providing fast access to the Intercity station at Market Harborough, Leicester and Melton Mowbray.

The property is offered to the market with NO CHAIN.

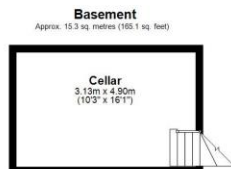
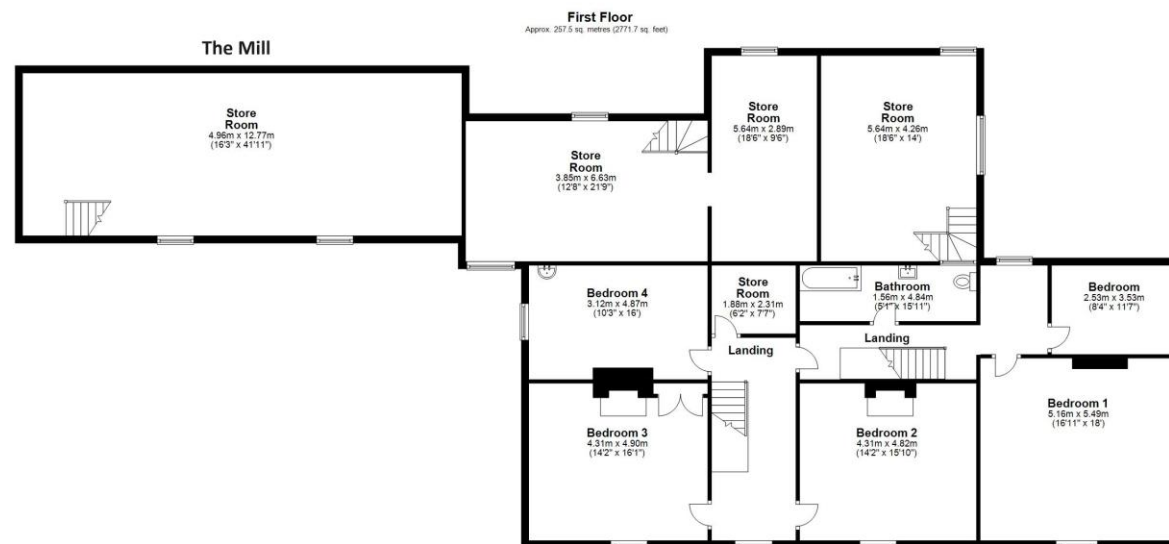
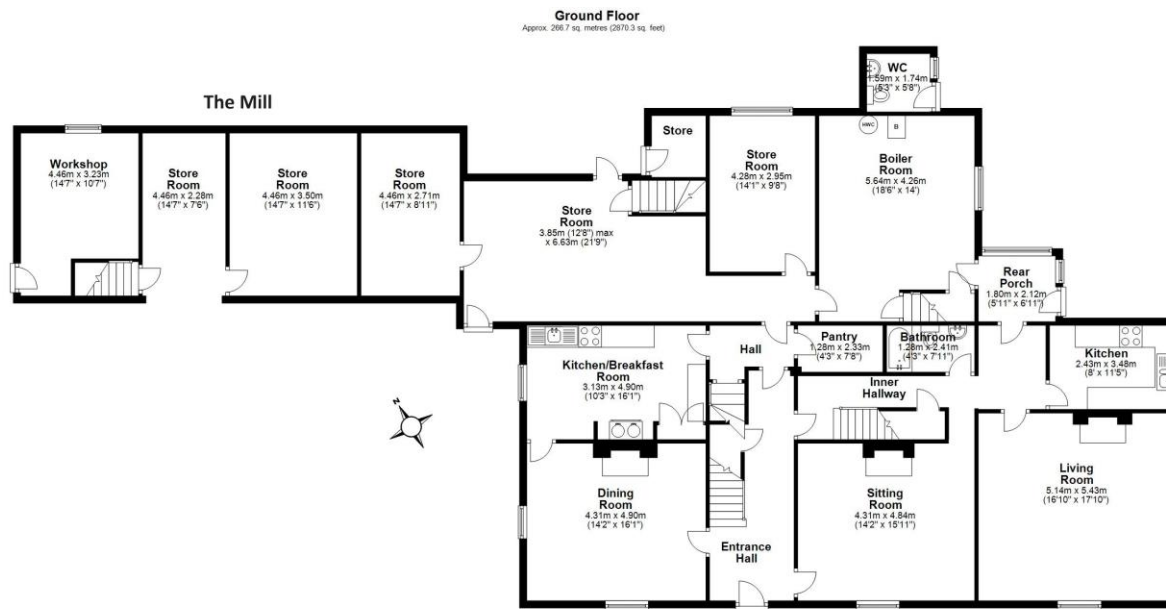

Total area: approx. 539.5 sq. metres (5807.1 sq. feet)

This floor plan is not to scale. They are for guidance only and accuracy is not guaranteed. Plan was produced by ADR Energy Assessors. Plan produced using PlanUp.

Moore V Ltd trading as Moores Estate Agents gives notice that: 1. These particulars do not constitute an offer or contract or part thereof. 2. All descriptions, photographs and plans are for guidance only and should not be relied upon as statements or representations of fact. All measurements are approximate and not necessarily to scale. Any prospective purchaser must satisfy themselves of the correctness of the information within the particulars by inspection or otherwise. 3. Moore V Ltd trading as Moores Estate Agents does not have any authority to give any representations or warranties whatsoever in relation to this property (including but not limited to planning/building regulations), nor can it enter into any contract on behalf of the Vendor. 4. Moore V Ltd trading as Moores Estate Agents does not accept responsibility for any expenses incurred by prospective purchasers in inspecting properties which have been sold, let or withdrawn. 5. If there is anything of particular importance to you, please contact this office and we will try to have the information checked for you.